

**ALLDAY
& MILLER**



William Close, Southall, UB2 4UP
£195,000

1 1 1 C



William Close, Southall, UB2 4UP

£195,000

- Ground Floor
- Private Garden
- Double Glazing
- Chain Free
- Off Street Parking
- Gas Heating
- Close To Amenities & Public Transport
- Quiet Location

Description

This house presents a wonderful opportunity for those seeking a comfortable home in the prime location. Although the property is in need of some improvements, it is brimming with potential for those looking to add their own touch and create a space that truly reflects their style.

The property features a well-proportioned reception/dining room, a bedroom, fitted kitchen and bathroom completes the property.

Additionally, the house benefits from a rear garden and off-street parking, a valuable feature in this bustling area.

Situation

William Close conveniently located within close access to both Southall and Greenford Broadway which offer ample shopping opportunities. There are several bus links on offer to Ealing, Northolt and Uxbridge town centre with the rider range of shopping facilities, restaurants and bars. The area is served by many highly regarded schools including Greenford High School, Lady Margaret and Allenby Primary Schools. Northolt Station which is serviced by the Central line is 2.4 miles away and Southall mainline station which offers links into London and the surrounding counties is only 1.1 miles away.



Floor Plans

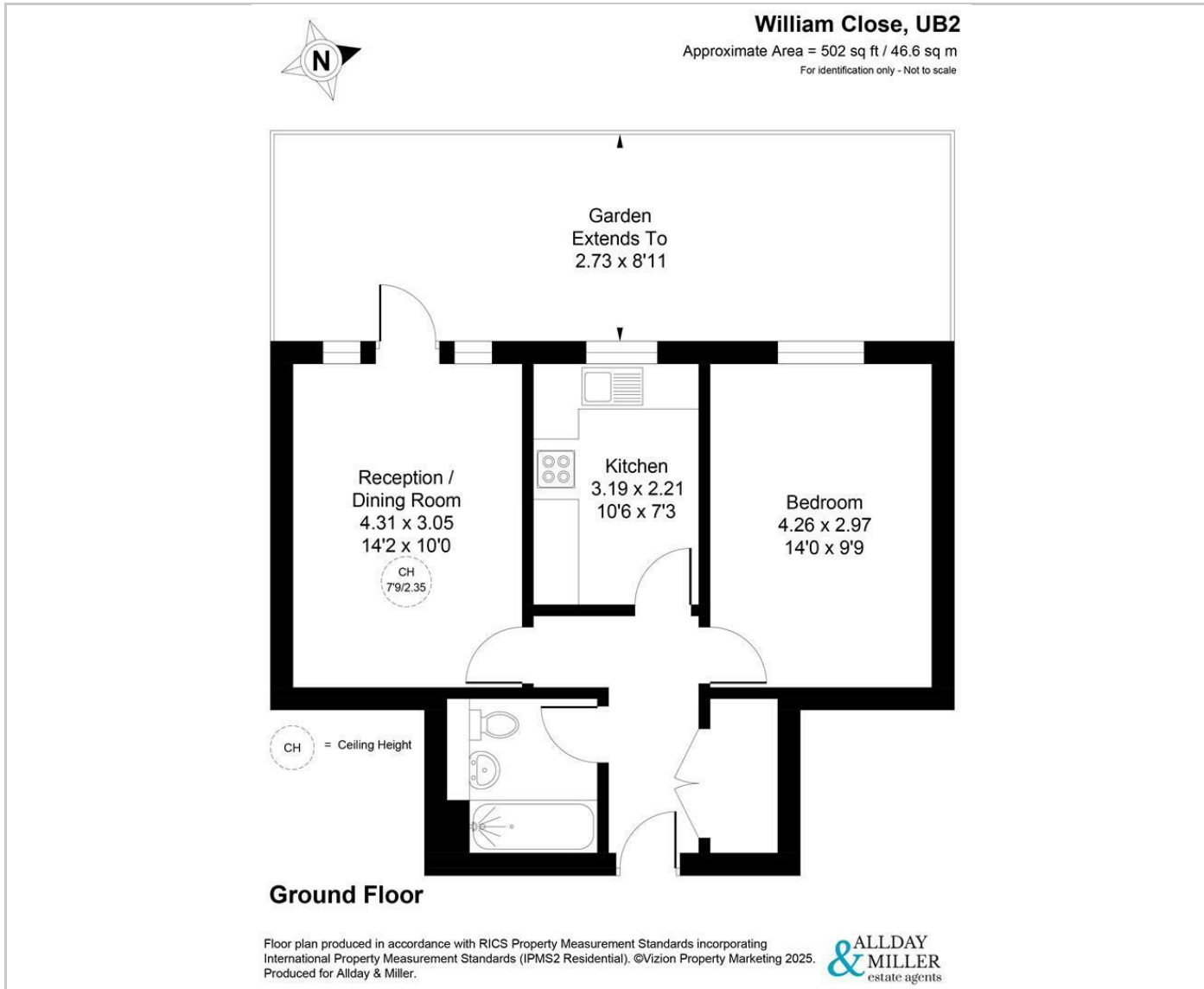

Area Map

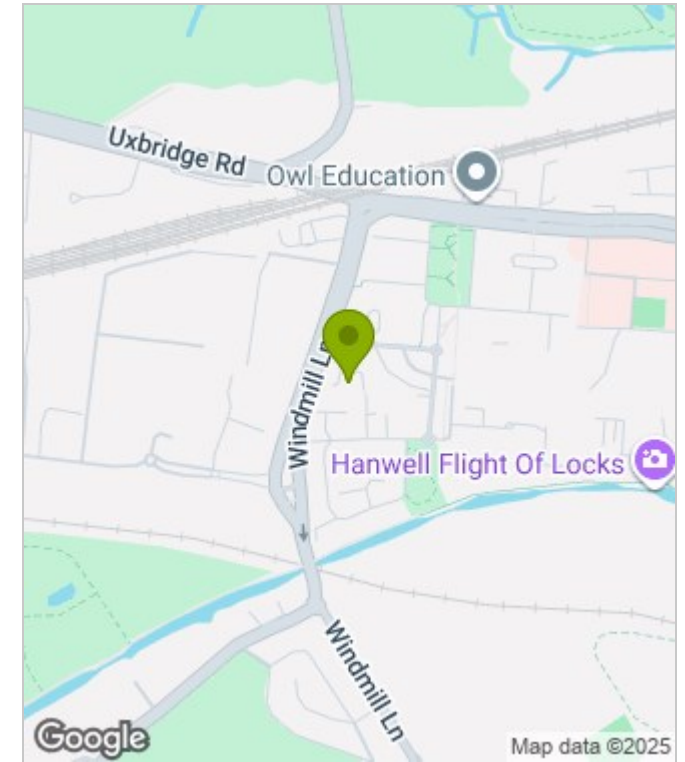

Energy Performance Graph

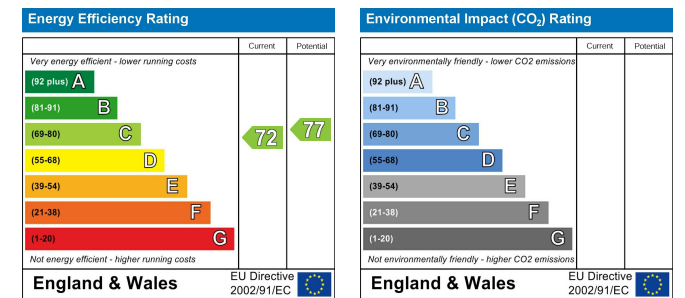

These particulars, whilst believed to be accurate are set out as a general outline only for guidance and do not constitute any part of an offer or contract. Intending purchasers should not rely on them as statements of representation of fact, but must satisfy themselves by inspection or otherwise as to their accuracy. No person in this firm's employment has the authority to make or give any representation or warranty in respect of the property.